

# FINGERPRINT BAG LOCK



Fingerprint



1 Years



Waterproof IP66



Security

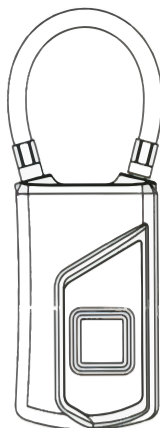

## I .USB Interface:

The product is charged by USB.  
Please fully charge the product for the first time.



### Components:

- 1.USB Port
- 2.Fingerprint Reader
- 3.LED Light
- 4.Wire Rope

## II .Indicator

Use 3-color indicator. Different indicator represents different devices and status.

Please check the details as below chart:

Indicator status	Function
Low power	Red light flash
Charging	Red light always on
Full charged	Lights off
Green light flash	Fingerprint collection mode
Green light always on	Successful to collect fingerprint
Blue light always on	Administrator fingerprint authorization
Green light flashes fast	Unlocked successfully
Red light always on	Delete fingerprint mode
Red light flash	Failed to collect fingerprint

## III .Description Of First Administrator' s Fingerprint Record

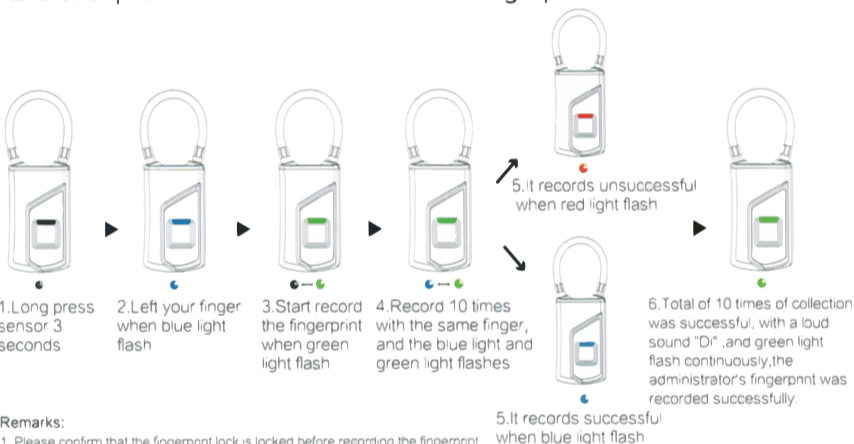

### Remarks:

1. Please confirm that the fingerprint lock is locked before recording the fingerprint.
2. Please pull out the lock rope manually after the fingerprint is unlocked successfully.
3. Please insert and press the lock rope when intend to lock.

## IV .Number 2 to 10 Fingerprint Recording Instructions

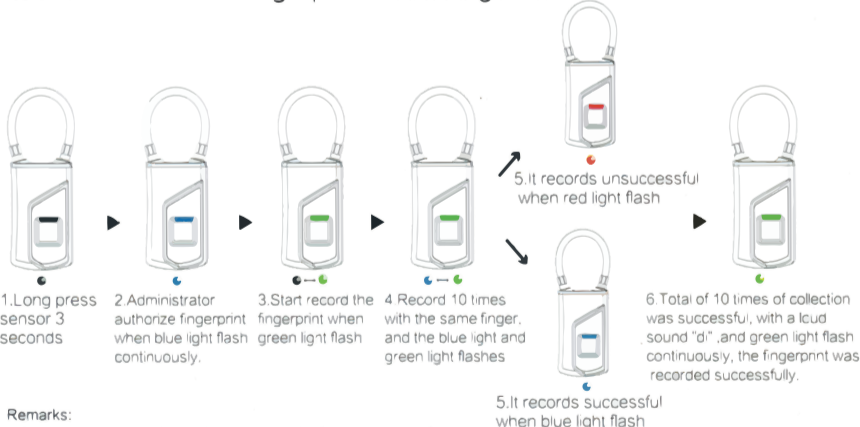

### Remarks:

1. Please confirm that the fingerprint lock is locked before recording the fingerprint.
2. The first and second fingerprints are the administrator fingerprint by default.
3. Collecting the second to tenth fingerprints requires administrator fingerprint authorization.

## V .Description Of Delete Fingerprint



### Remarks:

1. Please confirm that the fingerprint lock is locked before delete the fingerprint.
2. Only the administrator can delete the fingerprint and delete all the fingerprints at once.

## VI .Specifications

Support 360 degree angel fingerprint recognize  
Resolution: 508DPI  
ESD: +/- 12kV air, +/- 8kV contact  
FRR: <1%  
FAR: <0.002%  
Recognize time: <300mS  
Battery: 3.7V 240mAh(Unlock:1000 times)  
Standby time: 1 Year  
Charger: 5V 1A

## VII .Low voltage

When the voltage  $\leq 3.5V$ , the red indicator flash fast for 15s. If keep in the status of low batter, it will alarming per minute.